

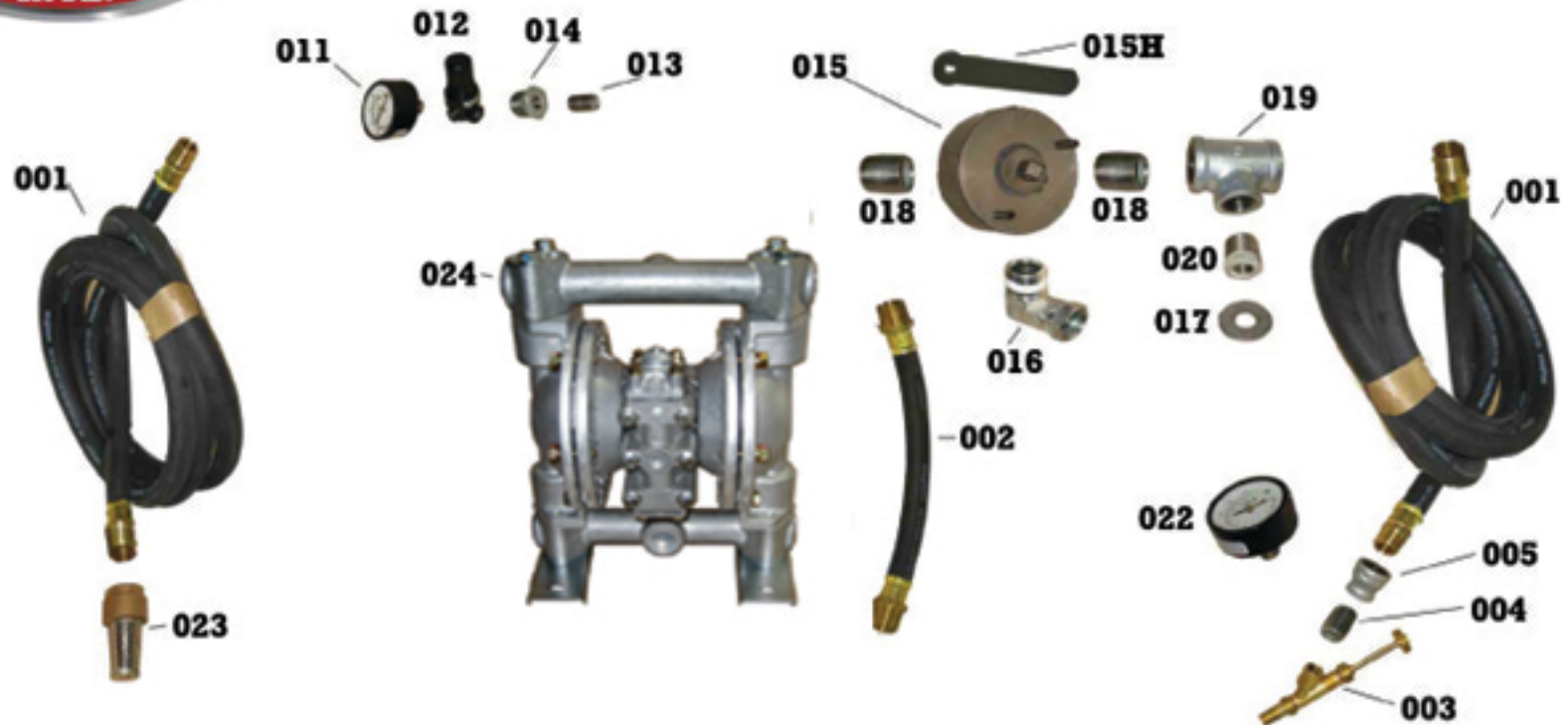

15100 YAMADA CALCIUM CHLORIDE PUMP PARTS BREAKDOWN



| Item Number | Part Number | Description | Qty | Item Number | Part Number | Description | Qty |
|-------------|-------------|-------------------------------|-----|-------------|-------------|-------------------------------------|-----|
| 1 | 15090-001 | Calcium Hose, 10' x 3/4" x 1" | 2 | 15 | 15090-015 | Hard Anodized Aluminum Valve Handle | 1 |
| 2 | 15090-002 | Calcium Hose, 16" x 1" x 1" | 1 | 16 | 15090-016 | Fitting, 1" with Swivel | 1 |
| 3 | 15090-003 | Calcium Injector Gun | 1 | 17 | 15090-017 | Flat Washer | 1 |
| 4 | 15090-004 | 1/2" Close Nipple | 1 | 18 | 15090-018 | 1" Close Nipple | 2 |
| 5 | 15090-005 | Coupling, 3/4" F x 1/2" F | 1 | 19 | 15090-019 | Tee, 1" x 3/4" | 1 |
| 10 | 15090-010 | Muffler | 1 | 20 | 15090-020 | Bushing, 3/4" M x 1/4" F | 1 |
| 11 | 15090-011 | Air Gauge, 1/8" Back Mount | 1 | 22 | 15090-022 | Air Gauge, 1/4" Back Mount | 1 |
| 12 | 15090-012 | Regulator | 1 | 23 | 15090-023 | Suction Strainer, 3/4" | 1 |
| 13 | 15090-013 | 1/4" Close Nipple | 1 | 24 | 15090-024 | Air Diaphragm Pump, 1" | 1 |
| 14 | 15090-014 | Bushing, 1/2" M x 1/4" F | 1 | | | | |

* 15905 Offered as standard product. Item ships complete with handle